

GUDI & Type III Aquifer Wells COGCC GIS Online Interactive Map

COGCC Operator Meeting

December 14, 2021



COLORADO
Oil & Gas Conservation
Commission
Department of Natural Resources

Greg Deranleau
Environmental Manager

General Information

- https://cogccmap.state.co.us/cogcc_gis_online/
- Map layers are a guidance only, and all PWS locations and buffer zones must be confirmed
 - Field measurements will carry the day
- Map layers are visible at 1:250,000 and less
 - Map layers are available as of 9:05 12/14/21—refresh your browser!
- PWS Contact info is made available from CDPHE, if found to be incorrect, contact the Source Water Protection Program at WQCD
- Definitions in Rule 411.b.(1)A—D
- Buffer Zones defined in Rule 411.b.(2)



Legend Organization and Labels



Layers

- Wells
- Locations
- Permits
- Facilities
- Directional Wellbores
- Flowlines (APPROVED)
- COGCC
- Historic Wells
- Roads & Railroads (CDOT)
- Water Resources (DWR & CDPHE)
 - Designated Groundwater Management Area
 - Designated Basin
 - Planned Reservoir
 - Lake
 - River/Stream
- Specified Area (CDPHE Regulation 42)
- Public Water System (PWS) Protection
 - Contacts
- Brighton 1-189
- Rule 411.a
- Rule 411.b
 - GUDI & Type III Wells - Generalized Internal Buffer
 - GUDI & Type III Wells - Generalized Intermediate Buffer
 - GUDI & Type III Wells - Generalized External Buffer

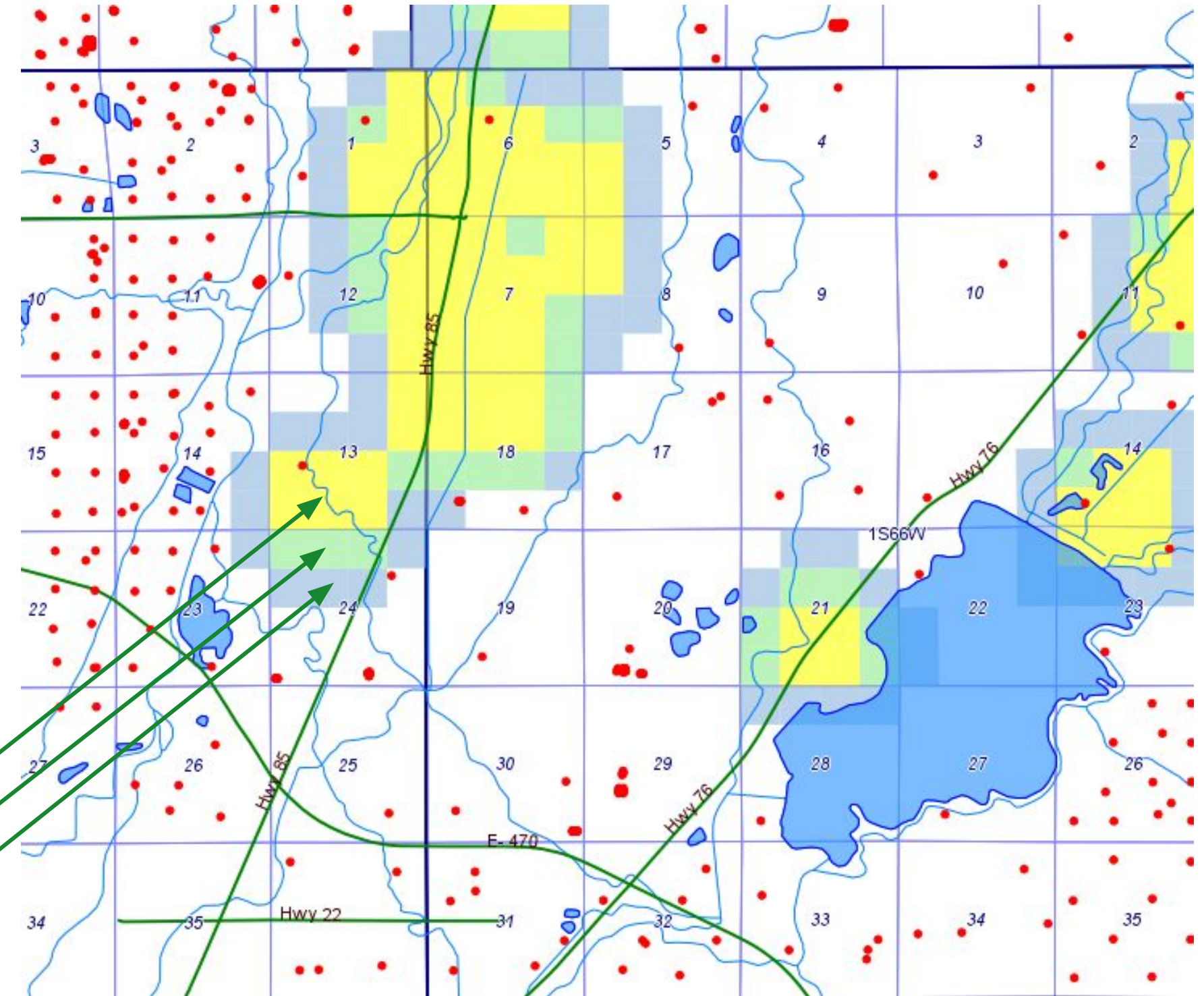

Internal Buffer Zone Map Tip

COGCC GISOnline Address Search Zoom Selection Results Intersect Add Point Redline Copy Lat/Long Print Help

Layers

- Wells
 - Well (API Spot)
 - Well Status
 - Underground Injection Control (UIC)
- Locations
- Permits
- Facilities
- Directional Wellbores
- Flowlines (APPROVED)
- COGCC
- Historic Wells
- Roads & Railroads (CDOT)
- Water Resources (DWR & CDPHE)
 - Water Well
 - Designated Groundwater Management Area
 - Designated Basin
 - Planned Reservoir
 - Lake
 - River/Stream
 - Specified Area (CDPHE Regulation 42)
 - Public Water System (PWS) Protection
 - Contacts
 - Brighton 1-189
 - Rule 411.a
 - Rule 411.b
 - GUDI & Type III Wells - Generalized Internal Buffer
 - GUDI & Type III Wells - Generalized Intermediate Buffer
 - GUDI & Type III Wells - Generalized External Buffer
- Floodplains (FEMA)
- Environmental Sites
- Air Quality (CDPHE)
- Section, Township, & Range (PLSS)
- Local Government Designees (LGDs)
- Parks & Wildlife (CPW)
- State Land (SLR)

South Adams County WSD
 ADMINISTRATIVE CONTACT:
 KEVIN PUSTULKA
 KPUSTULKA@SACWSD.ORG;
 (BUS) 720-206-0565;

CONTACT THE ADMINISTRATOR FOR
 THE PWS WELL LOCATION WHEN DETERMINING
 BUFFER ZONE APPLICABILITY.

COLORADO
 Oil & Gas Conservation
 Commission
 Department of Natural Resources

MAPGUIDE HELP

- Disclaimer
- Map Layer Info
- Map User Guide
- Other Browsers
- FAQ's
- Flowlines

This screen space is used for various map functions, such as redlining and measuring distances, and will change depending on the function being used.

Need help? Map not working?

Please contact:
 Chris Eisinger
 chris.eisinger@state.co.us
 (303)894-2100 x5111

X: 508725, Y: 4411113 (METER) 0 features selected 1: 70000.00 8.40 x 7.10 (mi) Powered by Infrastructure Map Server



Intermediate and External Buffer Zone Map Tip

The screenshot displays the COGCC GISOnline interface. The top toolbar includes tools for Address Search, Zoom, Selection Results, Intersect, Add Point, Redline, Copy, Lat/Long, Print, and Help. The Layers panel on the left lists various data layers, including Wells, Locations, Permits, Facilities, Directional Wellbores, Flowlines (APPROVED), COGCC, Historic Wells, Roads & Railroads (CDOT), Water Resources (DWR & CDPHE), Specified Area (CDPHE Regulation 42), Public Water System (PWS) Protection, Floodplains (FEMA), Environmental Sites, Air Quality (CDPHE), Section, Township, & Range (PLSS), Local Government Designees (LGDs), Parks & Wildlife (CPW), and State Land (SLR). The map area shows a grid of sections with various colored buffer zones (yellow, green, blue) and red dots representing wells. A tooltip over a well reads "See proximal internal buffer for PWS contact info." The right sidebar contains the Colorado Oil & Gas Conservation Commission logo, the text "COLORADO Oil & Gas Conservation Commission Department of Natural Resources", and a "MAPGUIDE HELP" section with links to Disclaimer, Map Layer Info, Map User Guide, Other Browsers, FAQ's, and Flowlines. Below the links is a note: "This screen space is used for various map functions, such as redlining and measuring distances, and will change depending on the function being used." At the bottom right, there is a "Need help? Map not working?" section with contact information for Chris Eisinger: chris.eisinger@state.co.us and (303)894-2100 x5111. The bottom status bar shows coordinates (X: 508892, Y: 4409724 (METER)), 0 features selected, a scale of 1: 70000.00, and a map extent of 8.40 x 7.10 (mi). The map is powered by Infrastructure Map Server.



*Thanks to Jane Stanczyk!
We'll miss you!*

colorado.gov/cogcc



COLORADO
Oil & Gas Conservation
Commission
Department of Natural Resources